

Briarwood Road, Aigburth, L17



For Sale - £140,000 Offers in Excess of

Key Features

- 1 Bedroom 1 Bathroom Terraced House
- EPC Rating: C71
- ****FULLY AVAILABLE**** No Onward Chain
- Fantastic Opportunity to Renovate & Add Value
- Rear Private Courtyard Garden
- Highly Sought After Location in Aigburth L17
- Perfect for First Time Buyers
- Great Investment Opportunity
- Previously a Two Bedroom
- Well Proportioned Room Sizes
- Close to Amenities & Popular Schools
- Excellent Local Facilities and Public Transport Links

Further Details

- Tenure: Freehold
- No. of Floors: 2
- Floor Space: 49 square metres / 524 square feet
- Council Tax Band: A
- Local Authority: Liverpool City Council
- Parking: On Street
- Outside Space: Back Yard
- Heating/Energy: Gas Central Heating, Double Glazing

Description

Atlas Estate Agents proudly presents a remarkable opportunity - a charming terraced house on Briarwood Road in Aigburth, L17, that's brimming with potential. With 49 square meters of space thoughtfully arranged over two floors, this property provides a canvas for your creative vision.

With a kitchen, reception room, one bedroom, and a bathroom spread over two floors, this property offers the ideal framework for your dream home.

The absence of an onward chain means you can dive into this project immediately, and a private courtyard garden provides a serene escape.

Situated in the highly desirable Aigburth L17 district, you'll have easy access to amenities, top schools, and excellent local facilities, not to mention great public transport links. Whether you're a first-time buyer looking to customize your space or an investor seeking a profitable opportunity, this previously two-bedroom gem boasts well-proportioned rooms ready to accommodate your vision.

Don't miss this fantastic opportunity to renovate and add significant value - contact Atlas Estate Agents today and unlock the potential of Briarwood Road!

Additional Images



Bedroom



Yard



Lounge



Kitchen



Bedroom



Yard

Floor Plans

GROUND FLOOR
273 sq.ft. (25.4 sq.m.) approx.

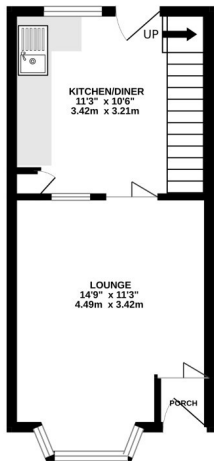

1ST FLOOR
251 sq.ft. (23.4 sq.m.) approx.

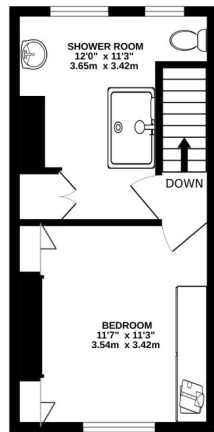

TOTAL FLOOR AREA: 524 sq.ft. (48.7 sq.m.) approx.
We warrant every offering has been made to ensure the accuracy of the foregoing information based on measurements of the property, which we believe to be correct. We do not warrant the accuracy of any other information or representations. A floor plan is for general guidance only and should not be used as a basis for any purchase or other transaction. The services, systems and appliances shown have not been tested and no guarantee as to their condition or efficiency can be given.
Maple Hill Mortgage Centre



Tel: 0151 727 2469
Fax: 0151 727 4943

Atlas Estate Agents, 2 Allerton Road,
Mossley Hill, Liverpool, L18 1LN

Email: sales@atlasestateagents.co.uk
Website: www.atlasestateagents.co.uk

These particulars are intended to give a fair and substantially correct overall description for the guidance of intending purchasers/tenants and do not constitute an offer or part of a contract. Please note that any services, heating systems or appliances have not been tested and no warranty can be given or implied as to their working order. Prospective purchasers/tenants ought to seek their own professional advice.

All descriptions, dimensions, areas, references to condition and necessary permissions for use and occupation and other details are given in good faith and are believed to be correct, but any intending purchasers/tenants should not rely on them as statements or representations of fact, but must satisfy themselves by inspection or otherwise as to the correctness of each of them.